

**QUICK
START
GUIDE**

WHAT'S IN THE BOX



2.4G Wireless Mouse



Nano USB Receiver



USB Type-C Charging Cable



User Manual

KNOW YOUR PRODUCT

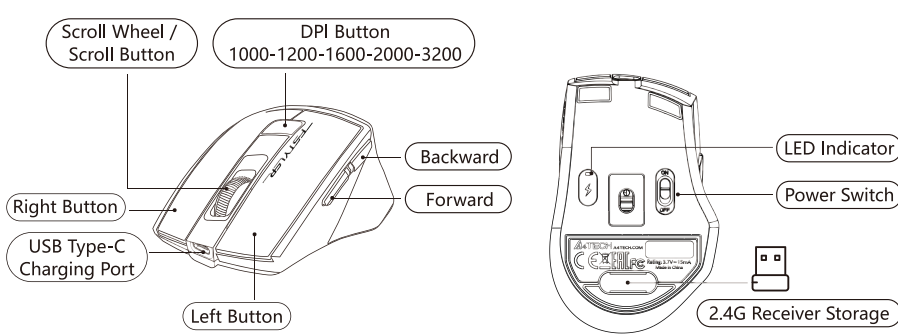

CONNECTING 2.4G DEVICE

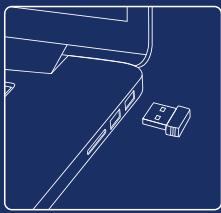

1 Plug the receiver into the computer's USB port.

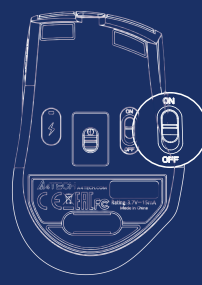

2 Turn the mouse power switch to on.

CHARGING & INDICATOR

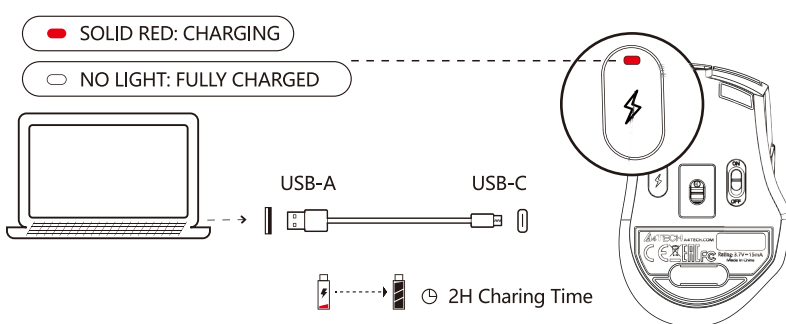

LOW BATTERY INDICATOR

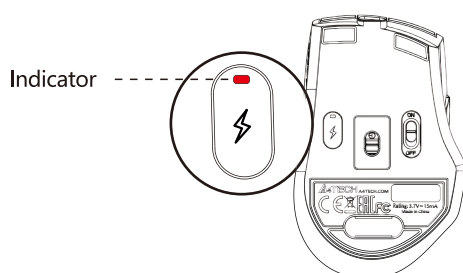

Flashing Red light indicates when the battery is below 25%.

16-IN-ONE SOFTWARE

You can set up the value-added functions such as 16 Gestures, Multimedia, Internet, 4-Way Wheel, etc. for the right, forward and backward buttons through the 16-in-One software.



Download Link:
<https://www.a4tech.com/download.aspx>

Note: Supports Windows System Only

TECH SPEC

Connection: 2.4G Hz	Buttons No.: 6
Sensor: Optical	Charging Cable: 60 cm
Operation Range: 10~15 m	Size: 105 x 70 x 42 mm
Style: Right-Handed Fit	Weight: 77 g (w/ battery)
Report Rate: 125 Hz	System: Windows 10 / 11
Resolution: 1000-1200-1600-2000-3200 DPI	

WARNING STATEMENT

The following actions may/will cause damages to the product.

1. To disassemble, bump, crush, or throwing into fire, you may cause irrefutable damages in event of the lithium battery leakage.
2. Do not expose under the strong sunlight.
3. Please obey all local laws when discarding the batteries, if possible please recycle it. Do not dispose it as household garbage, it may cause a fire or an explosion.
4. Please try to avoid charging in the environment below 0°C.
5. Do not remove or replace the battery.
6. Forbidden to use 6V to 24V charger, otherwise the product will be burned. Recommended to use a 5V charger for charging.



www.a4tech.com



Scan for E-Manual