

QUICK START GUIDE

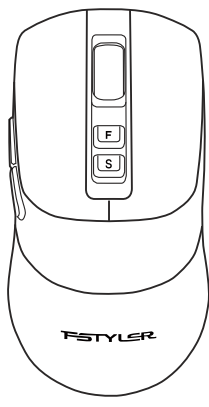

FB50C Plus
FB50CS Plus



WHAT'S IN THE BOX



Wireless
Mouse



Nano USB
Receiver



USB Type-C
Charging Cable



User
Manual

KNOW YOUR PRODUCT

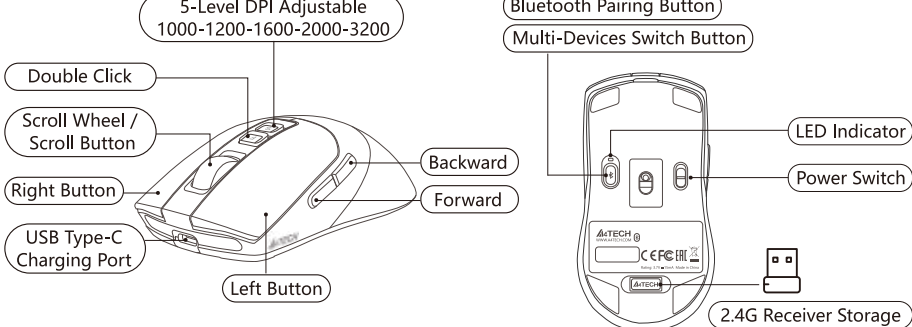

CONNECTING 2.4G DEVICE



1 Plug the receiver into the computer's USB port.

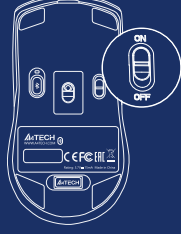

2 Turn the mouse power switch to on.



3 Indicator: Red and blue light will flash (10S). The light will be off after connected.

CONNECTING BLUETOOTH DEVICE 1 (For Mobile Phone/Tablet/Laptop)

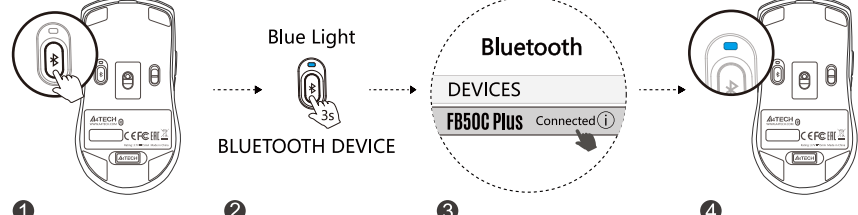

CONNECTING BLUETOOTH DEVICE 2 (For Mobile Phone/Tablet/Laptop)

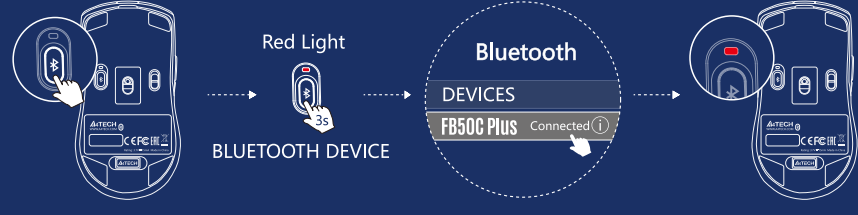

INDICATOR



MOUSE	2.4G DEVICE	BLUETOOTH DEVICE 1	BLUETOOTH DEVICE 2
Indicator	Red and Blue Light	Blue Light	Red Light
Switch Device: Short-Press 1S	Flashes Quickly 10S	Solid Light 5S	Solid Light 5S
Pair Device: Long-Press For 3S	No Need to Pair	Pairing: Flashes Slowly Connected: Solid Light 10S	Pairing: Flashes Slowly Connected: Solid Light 10S

The above indicator status is before Bluetooth paired. After the Bluetooth connection succeed, the light will turn off after 10S.

CHARGING & INDICATOR

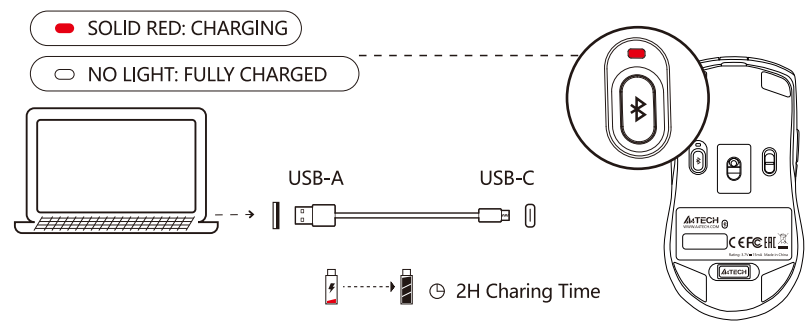

TECH SPEC



Connection: Bluetooth / 2.4GHz	Buttons No.: 7
Up to 3 Devices: Bluetooth x 2, 2.4GHz x 1	Receiver: Nano Receiver
Sensor: Optical	Charging Cable: 60 cm
Distance: 5~10 m	Size: 120 x 63 x 36 mm
Style: Symmetric	Weight: 79 g
Report Rate: 125 Hz	System: Windows / Mac / iOS / Chrome
Resolution: 1000-1200-1600-2000-3200 DPI	/ Android / Harmony OS...

Q & A



Question How many devices can be connected in total?

Answer Interchange and connect up to 3 devices at the same time.
2 Devices with Bluetooth + 1 Device with 2.4G Hz.

Question Does the mouse remember connected devices after power off?

Answer The mouse will automatically remember and connect last device.
You may switch the devices as you choose to.

Question How do I know what device is currently connected to?

Answer When the power is turned on, the indicator light will be displayed for 10S.

Question How to switch connected Bluetooth devices?

Answer Repeat the procedure of connecting Bluetooth devices.

WARNING STATEMENT



The following actions may/will cause damages to the product.

- To disassemble, bump, crush, or throwing into fire, you may cause irrefutable damages in event of the lithium battery leakage.
- Do not expose under the strong sunlight.
- Please obey all local laws when discarding the batteries, if possible please recycle it.
Do not dispose it as household garbage, it may cause a fire or an explosion.
- Please try to avoid charging in the environment below 0°C.
- Do not remove or replace the battery.
- Forbidden to use 6V to 24V charger, otherwise the product will be burned.
Recommended to use a 5V charger for charging.



www.a4tech.com



Scan for E-Manual