

WHAT'S IN THE BOX



Wireless Mouse



USB Type-C Adaptor



Nano USB Receiver

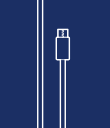

USB Type-C Charging Cable

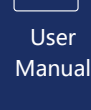

User Manual

KNOW YOUR PRODUCT

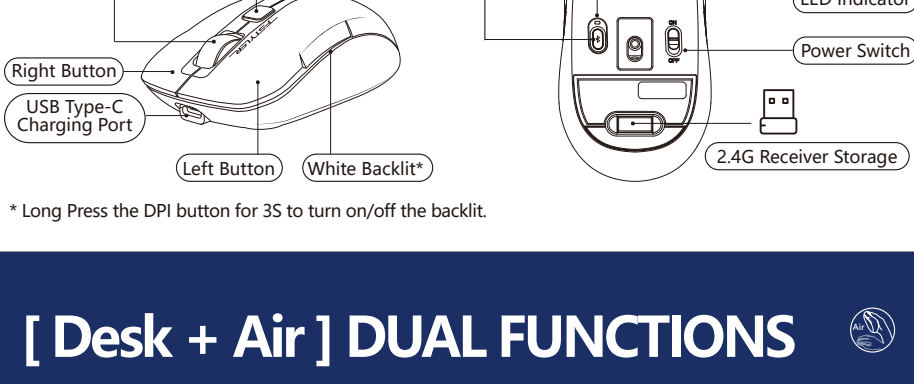

* Long Press the DPI button for 3S to turn on/off the backlit.

[Desk + Air] DUAL FUNCTIONS

The innovative Air Mouse Function provides dual [Desk+Air] usage modes, turn your mouse into a multimedia controller by simply lift it in the air. No software installation required.



Lift in AIR

1 On the Desk
Standard Mouse Performance

2 Lift in Air
Media Player Controller

LIFT IN AIR FUNCTION

To activate the Air Function, please follow the steps:

- Lift the mouse in the air.
- Hold both left and right buttons for 5s.

So now you can operate the mouse in the air and turn it into a multimedia controller with the below functions.

Left Button: Anti-Sleep Setting Mode (Long Press 3S)

Right Button: Play / Pause

Scroll Wheel: Volume Up / Down

Scroll Button: Mute

DPI Button: Open Media Player*

*Supports Windows System Only

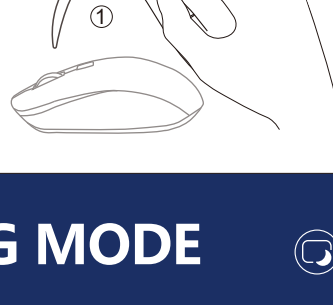

ANTI-SLEEP SETTING MODE

Note: Supports 2.4G Mode Only

To prevent your PC from entering the sleep-mode setting while you are away from your desk, simply turn on our new Anti-Sleep Setting Mode for PC.

It will automatically simulate the mouse cursor movement once you turn it on.

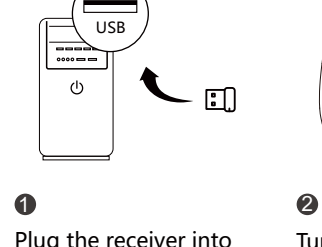

To turn on/off the Anti-Sleep Setting Mode for PC, please follow the steps:

- Lift the mouse in the air.
- Hold the left button for 3s.

CONNECTING 2.4G DEVICE



1 Plug the receiver into the computer's USB port.



2 Turn the mouse power switch to on.



3 Indicator: Red and blue light will flash (10S). The light will be off after connected.

2.4G RECEIVER CONNECT TYPE



1 USB Connect

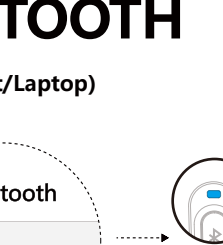

2 USB Type-C

CONNECTING BLUETOOTH DEVICE 1 (For Mobile Phone/Tablet/Laptop)

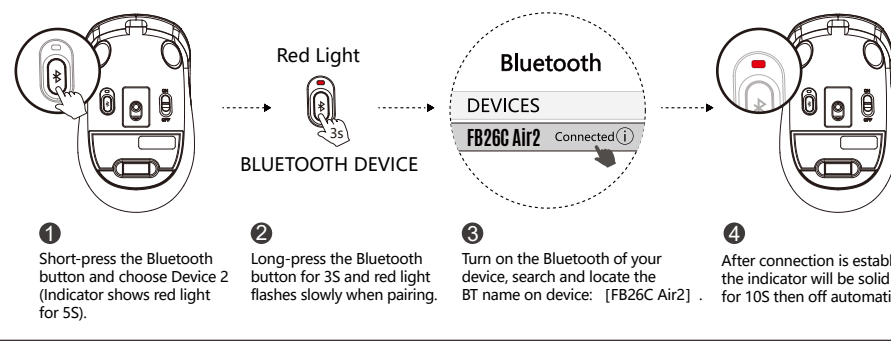

- Short-press the Bluetooth button and choose Device 1 (Indicator shows blue light for 5S).
- Long-press the Bluetooth button for 3S and blue light flashes slowly when pairing.
- Turn on the Bluetooth of your device, search and locate the BT name on device: [FB26C Air2].
- After connection is established, the indicator will be solid blue for 10S then off automatically.

CONNECTING BLUETOOTH DEVICE 2 (For Mobile Phone/Tablet/Laptop)

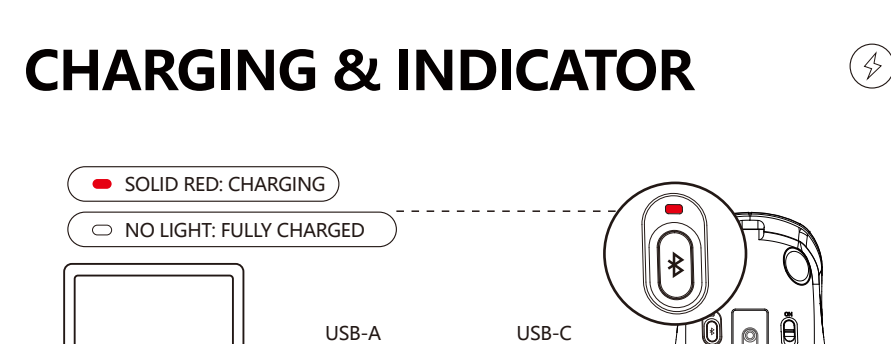

- Short-press the Bluetooth button and choose Device 2 (Indicator shows red light for 5S).
- Long-press the Bluetooth button for 3S and red light flashes slowly when pairing.
- Turn on the Bluetooth of your device, search and locate the BT name on device: [FB26C Air2].
- After connection is established, the indicator will be solid red for 10S then off automatically.

INDICATOR

MOUSE	2.4G DEVICE	BLUETOOTH DEVICE 1	BLUETOOTH DEVICE 2
Indicator	Red and Blue Light	Blue Light	Red Light
Switch Device: Short-Press 1S	Flashes Quickly 10S	Solid Light 5S	Solid Light 5S
Pair Device: Long-Press For 3S	No Need to Pair	Pairing: Flashes Slowly Connected: Solid Light 10S	Pairing: Flashes Slowly Connected: Solid Light 10S

The above indicator status is before Bluetooth paired. After the Bluetooth connection succeed, the light will turn off after 10S.

CHARGING & INDICATOR

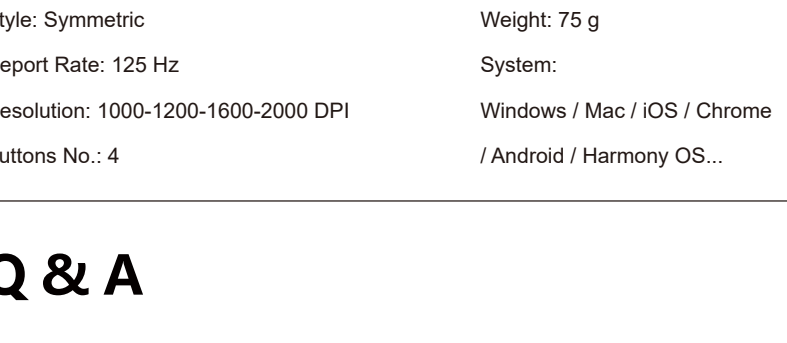

LOW BATTERY INDICATOR

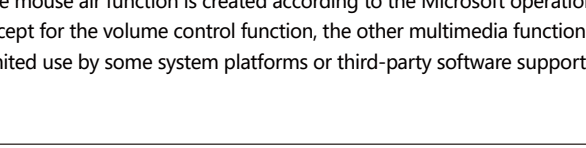

Flashing Red light indicates when the battery is below 25%.

TECH SPEC

Connection: Bluetooth / 2.4GHz	Backlit: White
Up to 3 Devices: Bluetooth x 2, 2.4GHz x 1	Receiver: Nano Receiver
Sensor: Optical	Charging Cable: 60 cm
Distance: 5~10 m	Size: 109 x 64 x 36 mm
Style: Symmetric	Weight: 75 g
Report Rate: 125 Hz	System:
Resolution: 1000-1200-1600-2000 DPI	Windows / Mac / iOS / Chrome
Buttons No.: 4	/ Android / Harmony OS...

Q & A

- Question** Do I need to install software for the [Desk+Air] mouse function?
Answer Just lift the mouse in the air, and hold both left and right buttons for 5s to enable the "Lift in Air" function, to turn it into a multimedia controller.
- Question** Is the air function fully compatible with all multimedia platforms?
Answer The mouse air function is created according to the Microsoft operation instructions. Except for the volume control function, the other multimedia functions might be limited use by some system platforms or third-party software support.
- Question** How many devices can be connected in total?
Answer Interchange and connect up to 3 devices at the same time.
 2 Devices with Bluetooth +1 Device with 2.4G Hz.
- Question** Does the mouse remember connected devices after power off?
Answer The mouse will automatically remember and connect last device.
 You may switch the devices as you choose to.
- Question** How do I know what device is currently connected to?
Answer When the power is turned on, the indicator light will be displayed for 10S.
- Question** How to switch connected Bluetooth devices?
Answer Repeat the procedure of connecting Bluetooth devices.

WARNING STATEMENT

- The following actions may/will cause damages to the product.
- To disassemble, bump/crush, or throwing into fire, you may cause irrefutable damages in event of the lithium battery leakage.
 - Do not expose under the strong sunlight.
 - Please obey all local laws when discarding the batteries, if possible please recycle it. Do not dispose it as household garbage, it may cause a fire or an explosion.
 - Do not try to avoid charging in the environment below 0°C.
 - Do not remove or replace the battery.
 - Forbidden to use 6V to 24V charger, otherwise the product will be burned. Recommended to use a 5V charger for charging.



www.a4tech.com



Scan for E-Manual